

SVF Series "TB" Tank bottom Valves

The Series "TB" Tank Bottom Valves are designed for fluid distribution systems in both high purity and industrial applications. These valves feature an ISO mounting pad to accommodate manual or automatic operation. All "TB" valves are inline weldable.

Key Features of the Design Include:

- Complete 316 SS Construction
- Meets ASME Boiler and Pressure Vessel codes
- "Flush Fill" mounting flange prohibits media entrapment
- Rotary operation for manual or automatic control
- Variety of interchangeable seats and seals
- Variety of end connections
- Suitable for a wide range of fluids
- Pressure rated to 900 WOG, non-shock
- Temperatures from -70oF to 650oF (See Pressure/Temperature table for full details)
- ISO Mounting Pad
- Live-Loaded Stem seals

Material Specifications

Sizes	3/4" to 4"
Body Material	Stainless Steel, ASTM A351-CF8M
Tank Flange	ASTM A351-CF8M 1"-3" 20 ^o 4" 16 ^o
Style	3-Piece Body
Stem	1-Piece SS Bottom Entry
Seat	TFE, RTFE, UHMWPE, NRG
Body Seal	TFE, UHMWPE
Stem Seal	RTFE, UHMWPE, NRG
Thrust Bearing	RTFE, UHMWPE
Body Bolts	ASTM A449 OR A193 Gr. 8 (304)
Body Nuts	ASTM A563 Gr. B OR A194 Gr. 8
Pipe Ends	FNPT, SW, BW, Tri-Clamp, TOBW, Flange
Purge Ports	Upon Request
Cavity Fillers	Upon Request
Electropolished	Upon Request

Applications

- Fluid Distribution Systems in:
- Pharmaceuticals
- BioTech
- Food & Beverage
- Chemicals
- Cosmetics
- Blending & Mixing
- Wherever fluids are stored and distributed through a tanking system

Note: SVF requires complete dimensional and geometrical information on the tank/vessel to ensure correct fit of valves and actuators.

SVF Series "TB" Tank bottom Valves

- SVF Tank bottom Valves Meet All Necessary Agency Standards
- ASME Boiler & Pressure Code, Section VIII, Division 1 Tank Bottom Flange
- ANSI B16.11, B16.25, B16.34, B31.1, B31.3

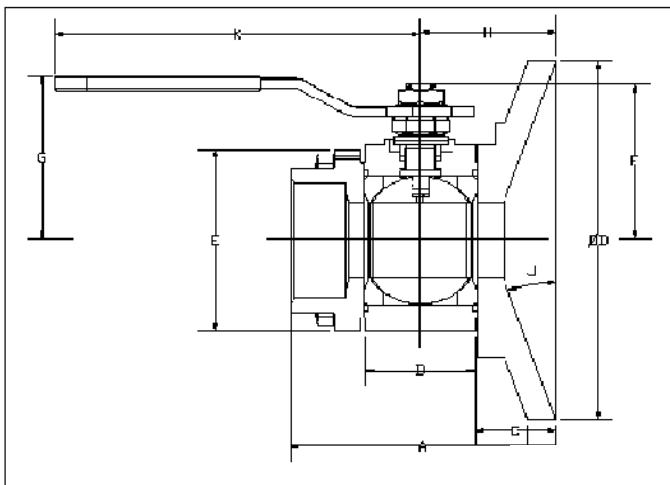
DIMENSIONAL DATA

Size	Port	A	B	C	D	F	G	H	J	K
¾"	0.56	2.70	0.97	0.81	2.76	1.59	1.87	1.29	20 ^Ø	4.49
1"	0.81	3.43	1.25	0.97	3.75	2.19	2.40	1.59	20 ^Ø	5.75
1 ½"	1.25	4.47	1.91	1.23	5.00	2.87	3.15	2.20	20 ^Ø	7.01
2"	1.50	5.01	2.22	1.38	6.00	3.07	3.31	2.51	20 ^Ø	7.01
2 ½"	2.00	5.99	2.86	1.58	8.00	2.92	5.59	3.01	20 ^Ø	8.90
3"	2.50	6.46	3.28	1.49	8.00	3.87	7.30	3.16	20 ^Ø	13.80
4"	3.25	7.99	4.28	1.64	10.00	4.49	7.92	3.80	16 ^Ø	22.00

HOW TO ORDER

SIZE	STYLE	BODY/ENDS	BALL/STEM	SEAT	SEAL	ENDS
¾"	R8	6-316L	6-316 SS	T- Virgin TFE	T- Virgin TFE	TB- Tank Bottom
1"	B8		3- Monel	R- Reinforced	B- BUNA	X
1.5"			8- A20	TFE	E- EPDM	SE- FNPT
2"			9- Hast C	A- TFM	G- Graphoil	SW- Socket Weld
2.5"				D- Delrin	V- Viton	BW- Butt Weld
				K- PEEK		
				N- NRG		
				U- UHMWPE		
				V- VX1		