



## Three-Piece Ball Valve, Standard Port, Sizes 1/4" ~ 3"



The SVF Series R8 Ball Valves feature a high performance design for use in critical, process-quality applications. These valves exceed the pressure & temperature ratings of traditional, general purpose ball valves.

### SERIES R8 DESIGN FEATURES

- ✓ High performance design for process-quality applications
- ✓ Encapsulated body seals to facilitate welding without disassembly
- ✓ Live-loaded stem packing ensures seal-tight pressure containment even under thermal cycling
- ✓ Three-piece "swing out" design offers easy access for in-line maintenance
- ✓ ISO 5211 mounting pad for easy actuation
- ✓ Standard seat material TFM1600™
- ✓ Blowout proof stem adds safety & reliability
- ✓ Stainless steel valves have 316L ends
- ✓ SupraLon™ seats for high temperature, steam, and thermal fluid applications
- ✓ Full range of options to suit specific requirements



The Series R8 Ball Valve is available with additional options. Contact SVF for more information.

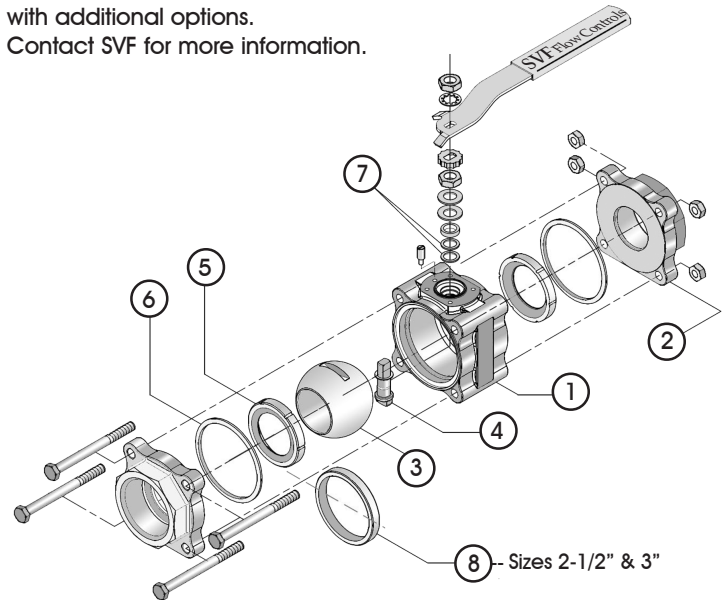

### MATERIALS OF CONSTRUCTION

ITEM	DESCRIPTION	MATERIALS SPECIFICATIONS (Additional options available)
1	Body	316 Stainless Steel (ASTM A351 CF8M) Carbon Steel (ASTM A216 WCB)
2	End Connector	316L Stainless Steel (ASTM A351 CF3M) Carbon Steel (ASTM A216 WCB)
3	Ball	316 Stainless Steel (ASTM A351 CF8M)
4	Stem	316 Stainless Steel (ASTM A276 Barstock) Stainless Steel 17-4 pH (ASTM A564 630 Barstock)
5	Seat	TFM1600™, SupraLon™, Delrin®, UHMWPE, PEEK
6	Body Seal	PTFE, Buna "N", SupraLon™, GRAFOIL®, UHMWPE, Viton®, EPDM
7	Stem Seal	SupraLon™
8	Retainer Sizes 2-1/2" & 3"	316 Stainless Steel

### SPECIFICATION STANDARDS OF COMPLIANCE

SVF Series R8 Ball Valves are available in designs that meet the following Industry Standards:

- ANSI
- ASME
- API
- DIN
- ISO
- MSS
- BPE
- NACE
- ASTM

Contact SVF for specific applications

What do you need today?™



www.SVF.net

## Three-Piece Ball Valve, Standard Port, Sizes 1/4" ~ 3"

**R8**

### DIMENSIONS, WEIGHT, Cv, TORQUE

Size	A		B		D		L		Weight.		Cv	Torque**	
	in.	mm	in.	mm	in.	mm	in.	mm	lbs	kg		in-lb <sub>f</sub>	Nm
1/4" *	2.60	66	0.44	11	5	127	1.8	45	2	0.9	3	45	5
3/8" *	2.60	66	0.44	11	5	127	1.8	45	2	0.9	5	45	5
1/2"	2.60	66	0.44	11	5	127	1.8	45	2	0.9	8	45	5
3/4"	2.81	71	0.56	14	5	127	1.9	48	2	0.9	12	45	5
1"	3.70	75	0.81	20	6	152	2.4	61	4	1.8	32	100	11
1-1/4"	4.25	106	1.00	25	6	152	2.6	66	5	2.2	57	130	14
1-1/2"	4.57	114	1.25	32	7	178	3.2	81	7	3.2	80	280	32
2"	5.04	128	1.50	38	7	178	3.3	84	11	5.0	104	360	41
2-1/2"	5.95	151	2.00	51	11	279	3.4	86	17	7.7	240	560	63
3"	6.68	170	2.50	63	14	355	7.3	185	30	13.6	320	1000	114

### R8 - PRESSURE/TEMPERATURE CHART

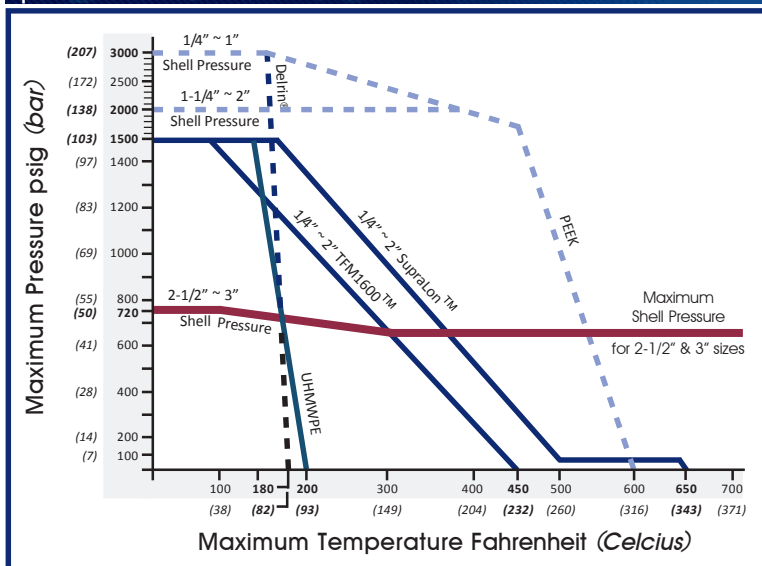

\* 1/4" and 3/8" are Full Port

\*\* At full differential pressure for clean fluids with TFM1600™ Seats

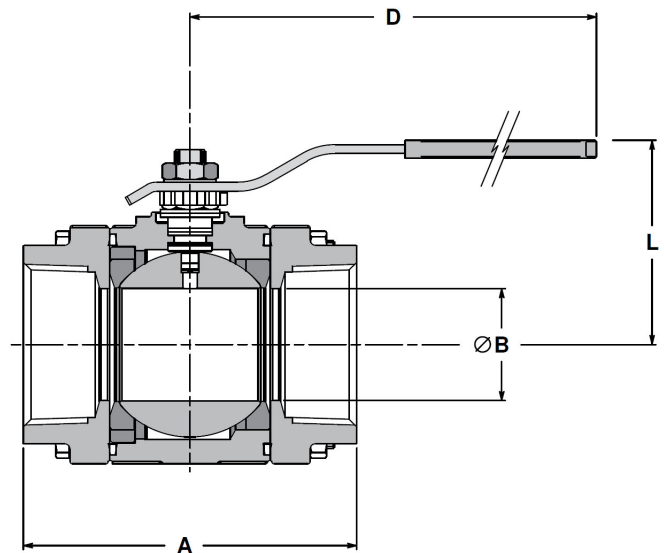

### HOW TO ORDER SERIES R8 BALL VALVES

SERIES	BODY & END MATERIAL	BALL & STEM MATERIAL	SEAT	BODY SEAL	ENDS	SIZE
R8	<b>44 = Carbon Steel</b> ASTM A216 WCB  <b>66 = 316 Stainless Steel</b> ASTM A351 CF8M Body CF3M 316L Ends  <b>88 = Alloy 20</b> ASTM A351 CN7M  <b>99 = Hastelloy</b> ASTM A494 CW1 2MW	<b>66 = 316 Stainless Steel</b> ASTM A351 CF8M Ball A276-316 Stem  <b>88 = Alloy 20</b> ASTM A351 CN7M  <b>99 = Hastelloy</b> ASTM A494 CW1 2MW  <b>33 = Monel</b> ASTM B164 N04400  <b>M = Stainless Steel 17-4 pH</b> ASTM A564 630 Stem Only	<b>A = TFM1600™</b>  <b>S = SupraLon™</b>  <b>D = Delrin®</b> (1/4" ~ 2" Only)  <b>U = UHMWPE</b>  <b>K = PEEK</b>	<b>T = PTFE</b>  <b>B = Buna "N"</b>  <b>S = SupraLon™</b>  <b>G = GRAFOIL®</b>  <b>U = UHMWPE</b>  <b>V = Viton®</b>  <b>E = EPDM</b>	<b>SE =</b> Screwed Ends (FNPT)  <b>SW =</b> Socket Weld Ends  <b>BW =</b> Butt Weld Ends  Other End Connection Options Available	<b>02 = 1/4"*</b> <b>12 = 1-1/4"</b> <b>03 = 3/8"*</b> <b>15 = 1-1/2"</b> <b>05 = 1/2"</b> <b>20 = 2"</b> <b>07 = 3/4"</b> <b>25 = 2-1/2"</b> <b>10 = 1"</b> <b>30 = 3"</b> *1/4" and 3/8" are Full Port
<b>Order Example: (R84466ATSE05)</b>						
<b>Example Description: Carbon Steel Body &amp; Ends, 316 Stainless Steel Ball &amp; Stem, TFM 1600™ Seat, PTFE Body Seal, Screwed Ends (FNPT), 1/2" Size</b>						
R8	44	66	A	T	SE	05