

Three-Piece Chlorine Service Ball Valve, Sizes 1/4" ~ 2"



The SVF Series C8 Ball Valve meets the Chlorine Institute Specifications (Pamphlet 6) for piping systems for Dry Chlorine Service.

This series is available with FNPT and socket weld end connections.

SERIES C8 DESIGN FEATURES

- ✓ Ideal for use in Dry or Liquid Chlorine Service
- ✓ Meets the Chlorine Institute Specifications (Pamphlet 6) for piping systems for Dry Chlorine Service
- ✓ Encapsulated body seals to facilitate welding without disassembly
- ✓ Live-loaded stem packing ensures seal-tight pressure containment even under thermal cycling
- ✓ Three-piece "swing out" design offers easy access for in-line maintenance
- ✓ ISO 5211 mounting pad for easy actuation
- ✓ Standard seat material is TFM1600™
- ✓ Blowout proof stem adds safety & reliability
- ✓ Full range of options to suit specific requirements



The Series C8 Ball Valve is available with additional options. Contact SVF for more information.

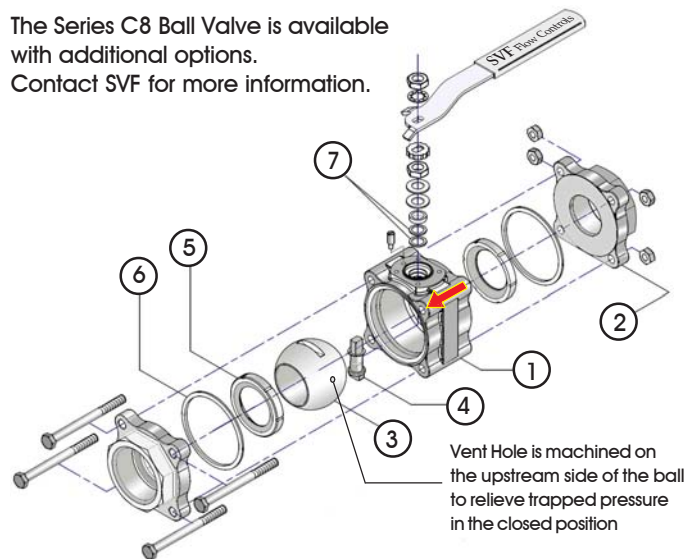

MATERIALS OF CONSTRUCTION

ITEM	DESCRIPTION	MATERIALS SPECIFICATIONS (Additional options available)
1	Body	Carbon Steel (ASTM A216 WCB)
2	End Connector	Carbon Steel (ASTM A216 WCB)
3	Ball	Monel (ASTM B164 N04400) Hastelloy (ASTM A494, CW 12MW)
4	Stem	Monel (ASTM B164 N04400) Hastelloy (ASTM A494, CW 12MW)
5	Seat	TFM1600™
6	Body Seal	PTFE
7	Stem Seal	SupraLon™

C8 MATERIAL RECOMMENDATIONS

Environment	Service	Max. Chlorine Conc. PPM of H ₂ O	Recommendation for Ball & Stem Material
Clean (no Chlorine in the air)	Mid-Line	20 ppm	Monel Ball & Stem
		50 ppm	Hastelloy Ball, Monel Stem
		150 ppm	Hastelloy Ball & Stem
Chlorine Contaminated	Mid-Line	150 ppm	Hastelloy Ball & Stem
Chlorine	End of Line	150ppm	Hastelloy Ball & Stem

What do you need today?™

HIGH PURITY
CleanFLOW
www.CleanFLOW.net

PRO-SPEC
PROCESS SPECIFIC
www.PRO-SPEC.NET

QUALITY FLOWS
THROUGH US

Three-Piece Chlorine Service Ball Valve, Sizes 1/4" ~ 2"



DIMENSIONS, WEIGHT, C_v, TORQUE

Size	A		B		D		L		Weight.		C _v	Torque**	
	in.	mm	in.	mm	in.	mm	in.	mm	lbs	kg		in-lb _f	Nm
1/4"*	2.60	66	0.44	11	5	127	1.8	46	2	0.9	3	45	5
3/8"*	2.60	66	0.44	11	5	127	1.8	46	2	0.9	5	45	5
1/2"	2.60	66	0.44	11	5	127	1.8	46	2	0.9	8	45	5
3/4"	2.81	71	0.56	14	5	127	1.9	48	2	0.9	12	45	5
1"	3.70	94	0.81	21	6	152	2.4	61	4	1.8	32	100	11
1-1/4"	4.25	108	1.00	25	6	152	2.6	66	5	2.3	57	130	15
1-1/2"	4.57	116	1.25	32	7	178	3.2	81	7	3.2	80	280	32
2"	5.04	128	1.50	38	7	178	3.3	84	11	5.0	104	360	41

C8 - PRESSURE/TEMPERATURE CHART

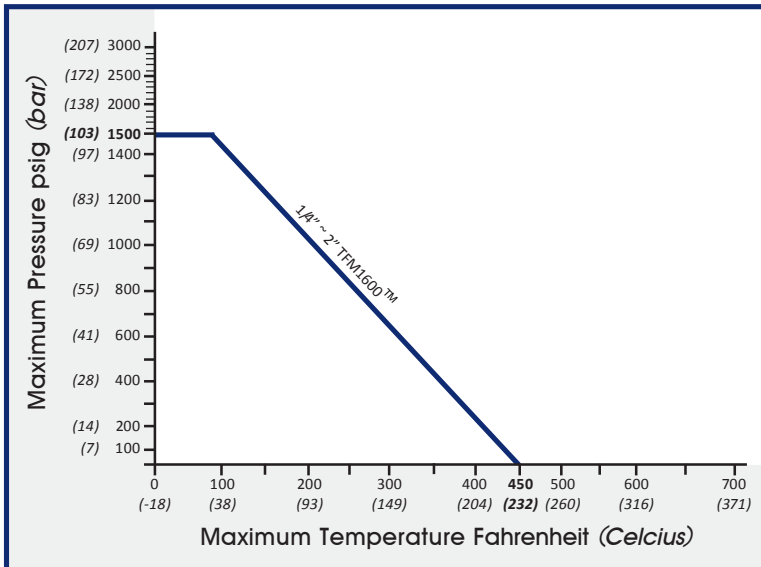

* 1/4" and 3/8" are Full Port

** At full differential pressure for clean fluids with TFM1600™ Seats

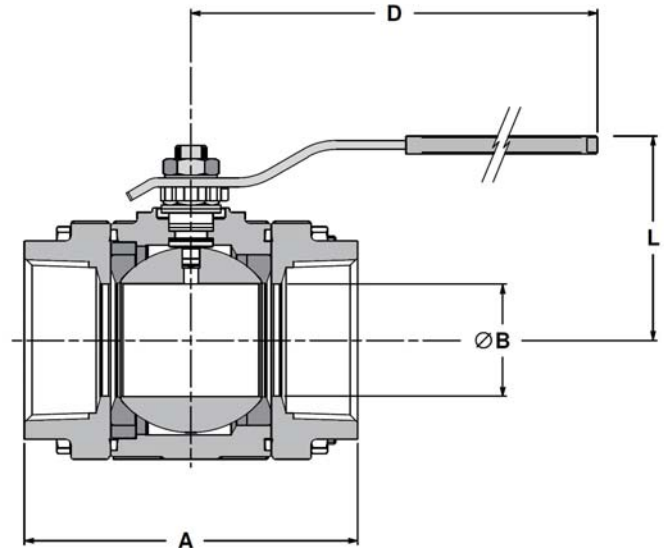

HOW TO ORDER SERIES C8 BALL VALVES

SERIES	BODY & END MATERIAL	BALL & STEM MATERIAL	SEAT	BODY SEAL	ENDS	SIZE
C8	44 = Carbon Steel ASTM A216 WCB	99 = Hastelloy ASTM A494 CW12MW 33 = Monel ASTM B164 N04400	A = TFM1600™	T = PTFE	SE = Screwed Ends (FNPT) SW = Socket Weld Ends Other End Connection Options Available	02= 1/4"* 10= 1" 03= 3/8"* 12= 1-1/4" 05= 1/2" 15= 1-1/2" 07= 3/4" 20= 2" *1/4" and 3/8" are Full Port
Order Example: (C84499ATSE05)						
Example Description: Carbon Steel Body & Ends, Hastelloy Ball & Stem, TFM1600™ Seat, PTFE Body Seal, Screwed Ends (FNPT), 1/2" Size						
C8	44	99	A	T	SE	05

Specifications subject to change. Please visit www.SVF.net for the latest updates on this Data Sheet. All Data Sheets posted on our website supersede all prior publications • [Document #DDS-C8-04/26/2010 • Series C8 Data Sheet - 04/26/2010]