



Scan the barcode with your SmartPhone app and view the latest publication of this document

Series H7 Ball Valve

Three-Piece High Pressure Ball Valve

Size 3/4"

H7-62

The SVF 3/4" Series H7 Code 62 Standard Port High-Pressure ball valve is designed to meet applications up to 6,000 psi. This performance engineered valve features a Stainless Steel Body and is available in a variety of alloy materials. The H7 adds safety and reliability to CNG high pressure systems.

SERIES H7-62 DESIGN FEATURES

- ✓ High pressure to 6,000 psi
- ✓ Live-loaded stem packing ensures seal-tight pressure containment even under thermal cycling
- ✓ Three-piece "swing out" design offers easy access for in-line maintenance
- ✓ Standard seat material is Delrin®
- ✓ Blowout proof stem adds safety & reliability
- ✓ Stainless Steel fasteners and handle



The Series H7-62 Ball Valve is available with additional options. Contact SVF for more information.

MATERIALS OF CONSTRUCTION

ITEM	DESCRIPTION	MATERIALS SPECIFICATIONS (Additional options available)
1	Body	316 Stainless Steel (ASTM A351 CF8M)
2	End Connector	316L Stainless Steel (ASTM A351 CF3M)
3	Ball	316 Stainless Steel (ASTM A351 CF8M)
4	Stem	Stainless Steel 17-4 PH (ASTM A564 630)
5	Seat	Delrin®, PEEK
6	Body Seal	Buna "N", Viton®, EPDM
7	Stem Seal	SupraLon™

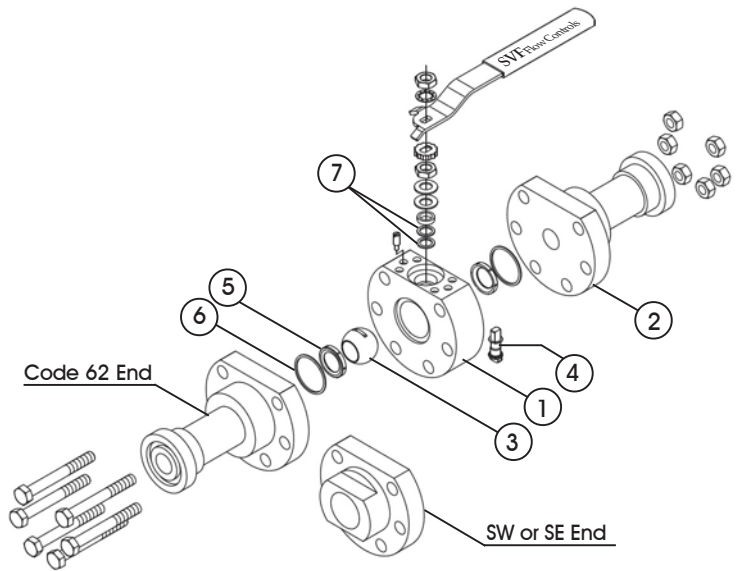

SPECIFICATION STANDARDS OF COMPLIANCE

SVF Series H7-62 Ball Valves are available in designs that meet the following Industry Standards:

- ANSI
- DIN
- BPE
- ASME
- ISO
- NACE
- API
- MSS
- ASTM

Contact SVF for specific applications

What do you need today?™

HIGH PURITY VALVES
CleanFLOW
CleanFLOWValves.net

PRO-SPEC
PROCESS SPECIFIC
WWW.PRO-SPEC.NET

QUALITY FLOWS
THROUGH US

Specifications subject to change. Please visit www.SVF.net for the latest updates on this Data Sheet. All Data Sheets posted on our website supersede all prior publications • [Document # SVF_H7-62_Data_Sheet - 04/12/2012]

www.SVF.net

SVF Flow Controls, Inc. • 13560 Larwin Circle • Santa Fe Springs, CA 90670 • Tel: 1.800.783.7836 • FAX: 562.802.3114
Sales@SVF.net • Visit our website: www.SVF.net • © SVF Flow Controls, Inc. • Specifications subject to change without notice



Scan the barcode with your
SmartPhone app and view the
latest publication of this document

DIMENSIONS, WEIGHT, C_v, TORQUE

End Connections	A		B		D		L		Weight.		C _v	Torque*	
	in.	mm	in.	mm	in.	mm	in.	mm	lbs	kg		in-lb _f	Nm
Code 62 X Code 62 End	8.12	206	0.56	14	5	127	1.9	48	6.2	2.8	12	200	23
Code 62 X SW/SE End	5.76	146	0.56	14	5	127	1.9	48	5.5	2.5	12	200	23

* At full differential pressure for clean fluids with Delrin® Seats

PRESSURE/TEMPERATURE CHART

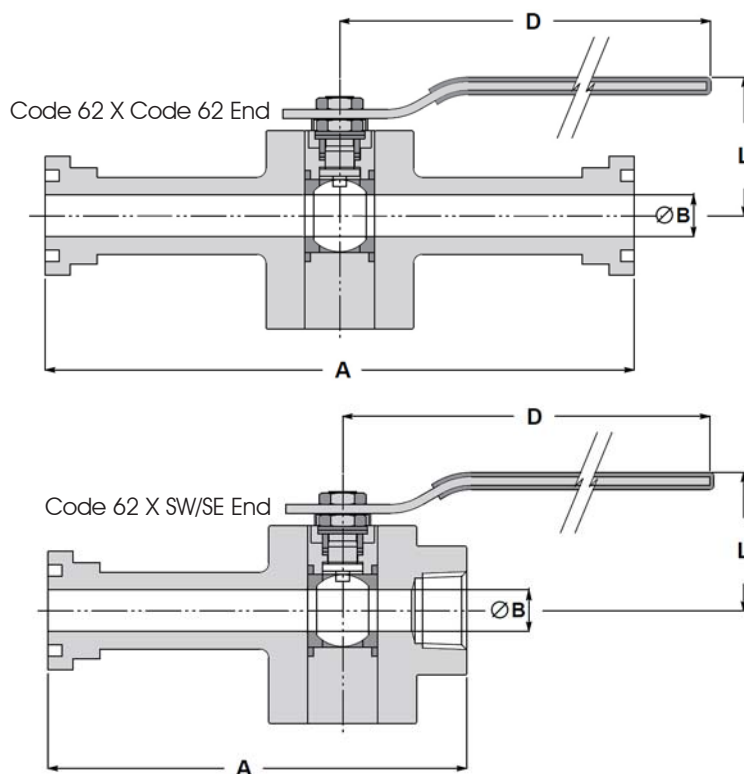
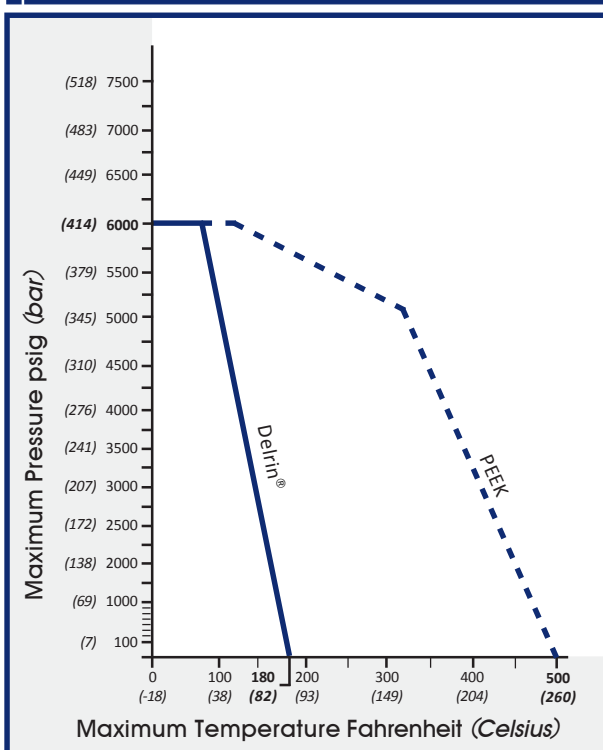

HOW TO ORDER SERIES H7-62 BALL VALVES

SERIES	BODY & END MATERIAL	BALL & STEM MATERIAL	SEAT	BODY SEAL	ENDS	SIZE
H7 = Standard Port	66 = Body: 316 Stainless Steel ASTM A351 CF8M Ends: 316L Stainless Steel ASTM A351 CF3M	6M = 316 Stainless Steel ASTM A351 CF8M Ball 17-4PH ASTM A564 630 Stem	D = Delrin® K = PEEK	B = Buna "N" V = Viton® E = EPDM	UFA = Code 62 Ends SEUFA = Screwed End (FNPT) x Code 62 End SWUFA = Socket Weld End x Code 62 End	07 = 3/4"

Order Example: (H7666MDBUFA07)

Example Description:

316L Stainless Steel Body & Ends, 316 Stainless Steel Ball, 17-4ph Stem, Delrin® Seat, Buna "N" Body Seal, Code 62 Ends, 3/4" Size

H7	66	6M	D	B	UFA	07
----	----	----	---	---	-----	----

Specifications subject to change. Please visit www.SVF.net for the latest updates on this Data Sheet. All Data Sheets posted on our website supersede all prior publications • [Document # SVF_H7-62_Data_Sheet - 04/12/2012]