



Scan the barcode with your  
SmartPhone app and view the latest  
publication of this document

# Series B8 Ball Valve

## Three-Piece Ball Valve, Full Port

### Sizes 1/2" ~ 2-1/2"



The SVF Series B8 Ball Valves feature a high performance design for use in critical, process-quality applications. These valves exceed the pressure & temperature ratings of traditional, general purpose ball valves.

### SERIES B8 DESIGN FEATURES

- ✓ Full ported flow path in a high performance design for process-quality applications
- ✓ Encapsulated body seals to facilitate welding without disassembly
- ✓ Live-loaded stem packing ensures seal-tight pressure containment even under thermal cycling
- ✓ Three-piece "swing out" design offers easy access for in-line maintenance
- ✓ ISO 5211 mounting pad for easy actuation
- ✓ Standard seat material is TFM1600™
- ✓ Blowout proof stem adds safety & reliability
- ✓ Stainless steel valves have 316L ends
- ✓ Full range of options to suit specific requirements



The Series B8 Ball Valve is available with additional options. Contact SVF for more information.

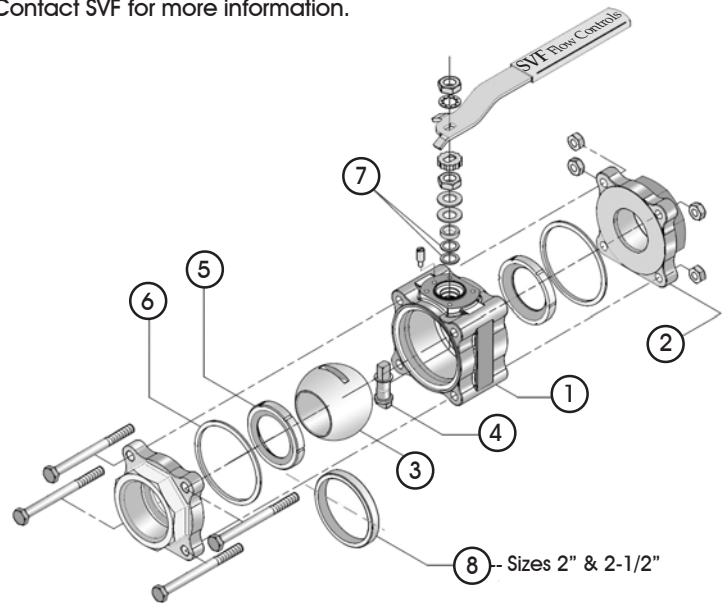

### MATERIALS OF CONSTRUCTION

ITEM	DESCRIPTION	MATERIALS SPECIFICATIONS (Additional options available)
1	Body	316 Stainless Steel (ASTM A351 CF8M) Carbon Steel (ASTM A216 WCB)
2	End Connector	316L Stainless Steel (ASTM A351 CF3M) Carbon Steel (ASTM A216 WCB)
3	Ball	316 Stainless Steel (ASTM A351 CF8M)
4	Stem	316 Stainless Steel (ASTM A276) Stainless Steel 17-4 pH (ASTM A564 630)
5	Seat	TFM1600™, Delrin®, UHMWPE, PEEK
6	Body Seal	PTFE, Buna "N", GRAFOIL®, UHMWPE, Viton®, EPDM
7	Stem Seal	SupraLon™
8	Retainer Sizes 2" & 2-1/2"	316 Stainless Steel

### SPECIFICATION STANDARDS OF COMPLIANCE

SVF Series B8 Ball Valves are available in designs that meet the following Industry Standards:

- ANSI
- DIN
- BPE
- ASME
- ISO
- NACE
- API
- MSS
- ASTM

Contact SVF for specific applications

**What do you need today?™**



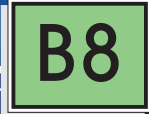

### DIMENSIONS, WEIGHT, Cv, TORQUE

Size*	A		B		D		L		Weight.		Cv	Torque**	
	in.	mm	in.	mm	in.	mm	in.	mm	lbs	kg		in-lb <sub>f</sub>	Nm
1/2"	2.81	71	0.56	14	5	127	1.9	48	2	0.9	12	45	5
3/4"	3.70	94	0.81	21	6	152	2.4	61	4	1.8	32	100	11
1"	4.25	108	1.00	25	6	152	2.6	66	5	2.3	57	130	15
1-1/4"	4.57	116	1.25	32	7	178	3.2	81	7	3.2	80	280	32
1-1/2"	5.04	128	1.50	38	7	178	3.3	84	11	5.0	104	360	41
2"	5.95	151	2.00	51	11	279	3.4	86	17	7.7	240	560	63
2-1/2"	6.68	170	2.50	64	14	356	7.3	185	30	13.6	320	1000	113

### B8 - PRESSURE/TEMPERATURE CHART

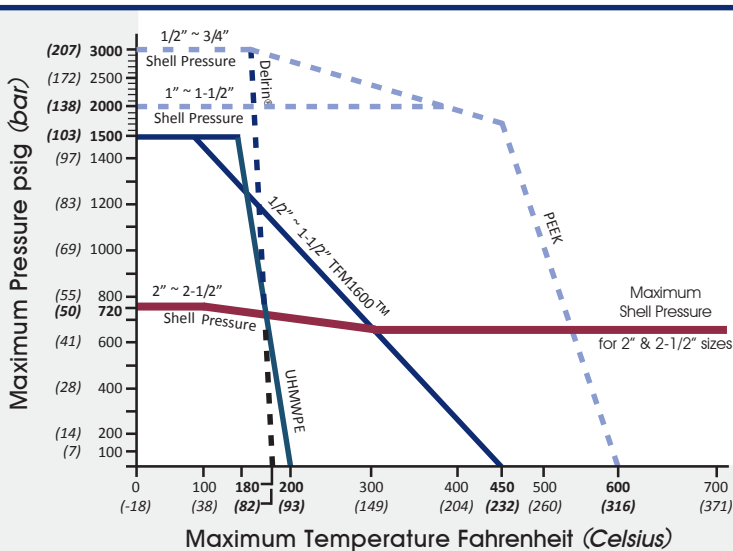

\* For 1/4" and 3/8" Full Port - See R8 Data Sheet

\*\* At full differential pressure for clean fluids with TFM1600™ Seats

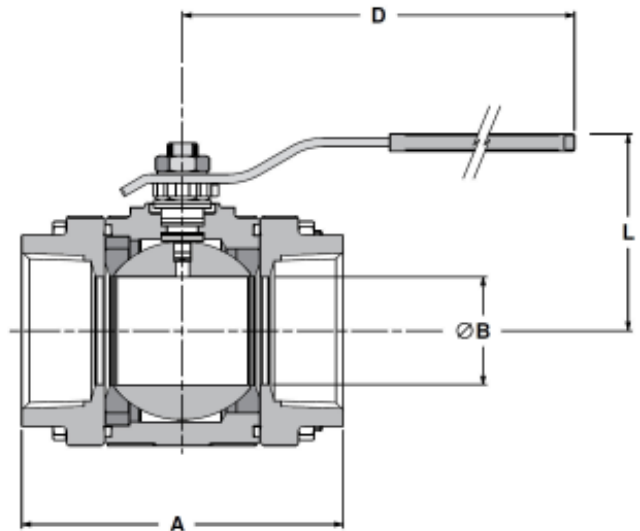

### HOW TO ORDER SERIES B8 BALL VALVES

SERIES	BODY & END MATERIAL	BALL & STEM MATERIAL	SEAT	BODY SEAL	ENDS	SIZE
B8	<b>44</b> = Carbon Steel ASTM A216 WCB  <b>66</b> = 316 Stainless Steel ASTM A351 CF8M Body CF3M 316L Ends  <b>88</b> = Alloy 20 ASTM A351 CN7M  <b>99</b> = Hastelloy ASTM A494 CW12MW	<b>66</b> = 316 Stainless Steel ASTM A351 CF8M Ball A276-316 Stem  <b>88</b> = Alloy 20 ASTM A351 CN7M  <b>99</b> = Hastelloy ASTM A494 CW12MW  <b>33</b> = Monel ASTM B164 N04400  <b>6M</b> = Stainless Steel 17-4 pH ASTM A564 630 Stem Only	<b>A</b> = TFM1600™  <b>D</b> = Delrin® (1/2" ~ 1-1/2" Only)  <b>U</b> = UHMWPE  <b>K</b> = PEEK (Requires 17-4 Stem)	<b>T</b> = PTFE  <b>B</b> = Buna "N"  <b>G</b> = GRAFOIL®  <b>U</b> = UHMWPE  <b>V</b> = Viton®  <b>E</b> = EPDM	<b>SE</b> = Screwed Ends (FNPT)  <b>SW</b> = Socket Weld Ends  <b>BW</b> = Butt Weld Ends  Other End Connection Options Available	<b>05</b> = 1/2" <b>12</b> = 1-1/4" <b>07</b> = 3/4" <b>15</b> = 1-1/2" <b>10</b> = 1" <b>20</b> = 2" <b>25</b> = 2-1/2" *02 = 1/4" - Full Port *03 = 3/8" - Full Port See R8 Data Sheet
Order Example: (B84466ATSE05)						
Example Description: Carbon Steel Body & Ends, 316 Stainless Steel Ball & Stem, TFM 1600™ Seat, PTFE Body Seal, Screwed Ends (FNPT), 1/2" Size						
B8	44	66	A	T	SE	05